

schenckAccuRate



## DEA 300/600 Weighbelt Feeders

DEA 300/600  
Weighbelt Feeders

**APPLICATIONS:** Can be used for weight controlled feeding, as a weight indicator and totalizer, or for batching.

**FEED RATES:** DEA 300 up to 660 ft<sup>3</sup> (18,961 liters) per hour. DEA 600 up to 1,680 ft<sup>3</sup> (47,578 liters) per hour. Feed rates are dependent on material characteristics. Contact us for estimated feed rates.

**FEEDER ACCURACY:** + 0.25% to 1% of set rate at 2 Sigma, depending on material characteristics.

**MATERIAL PARTICLE SIZE:** 1.5" (38 mm) diameter with high flow gate at maximum.

**TEMPERATURE LIMITS:** 15° F to 104° F (-9.4° to 40° C). Higher temperatures are attainable depending on belt speed and other conditions. Contact us for more information.

**BELT WIDTH:** DEA 300 is 12 inches (305 mm)  
DEA 600 is 24 inches (610 mm)

**BELT TYPES:** White polyurethane, FDA approved. Other belt materials are available for high temperatures or extreme chemical exposure.

**LOAD CELL:** Single point, strain gage type, stainless steel, compensated temperature range of +15° to 104° F (-9.4° to 40° C).

**MOTOR:** 1/3 HP, 90 Volt DC, TENV, IP54 or 1/2 HP, 200/430 VAC Volt (50 Hz) and 230/460 VAC (60 Hz), TEFC, IP55

**ENCLOSURES:** The enclosure is all stainless steel with removable top, side, and front closed cell gasket covers.

**MATERIALS OF CONSTRUCTION:** All contact and non-contact surfaces are 304 Series Stainless Steel. All non-metal components are FDA approved materials.

**INLET SHEAR GATE:** Low, medium, and high flow gates are shipped with each unit. Each gate is adjustable.

**CONVEYOR:** Cantilevered stainless steel construction allows for quick belt removal. For easy removal, cam take-up provides slack without loosening tracking adjustments.

**BELT INFLUENCE COMPENSATION:** (BIC) Statistical process which continually learns and compensates for the changes in the belt profile due to age, material build-up or temperature. Monitors belt weight, slippage and tracking. See BIC specification sheet for a more detailed explanation.

**AUTOMATIC BELT CLEANING SYSTEM:** Spring-loaded head pulley scraper and gravity-loaded internal plow automatically clean both sides of the belt.

**AUTOMATIC BELT TRACKING SYSTEM:** Constant tension tracking system automatically tracks belt and minor shifts of the belt.

**CONTROLS:** Intecon or DISOCONT® for single applications; DISOCONT® with DG-2000™ software for multiple applications.

**ELECTRICAL POWER REQUIREMENTS:**  
For DC Drive System: 110 VAC or 220 VAC single-phase, 50/60 Hz.

For AC Drive System: 220 VAC single- or three-phase, 460V three-phase, 50/60 Hz.

**OPTIONS:** Sample valve, flexible connectors, extended lengths and dust collector collars.

**WEIGHT:**  
DEA 300 Estimated equipment weight: 275 lbs (125 kg)  
DEA 300 Estimated shipping weight: 340 lbs (154 kg)  
DEA 600 Estimated equipment weight: 575 lbs (261 kg)  
DEA 600 Estimated shipping weight: 725 lbs (329 kg)

**For more information, please contact us at  
1-800-558-0184 or Fax: 262-473-4384  
E-mail: [mktg@accuratefeeders.com](mailto:mktg@accuratefeeders.com)  
Web site: [www.accuratefeeders.com](http://www.accuratefeeders.com)**

Specifications

# Specifications

## DEA 300/600 Weighbelt Feeders

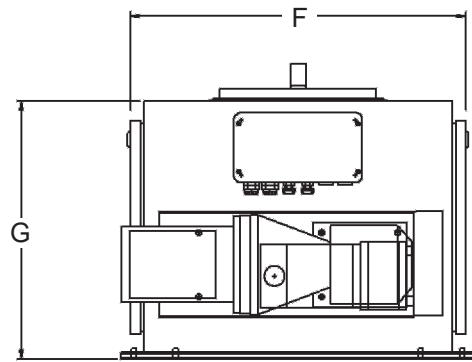
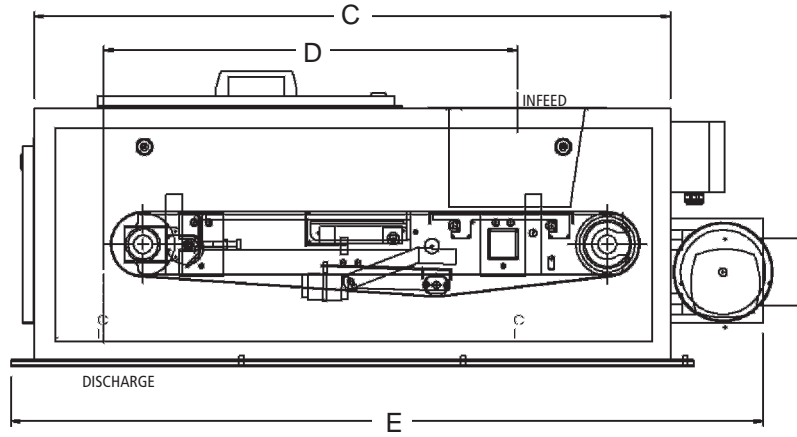
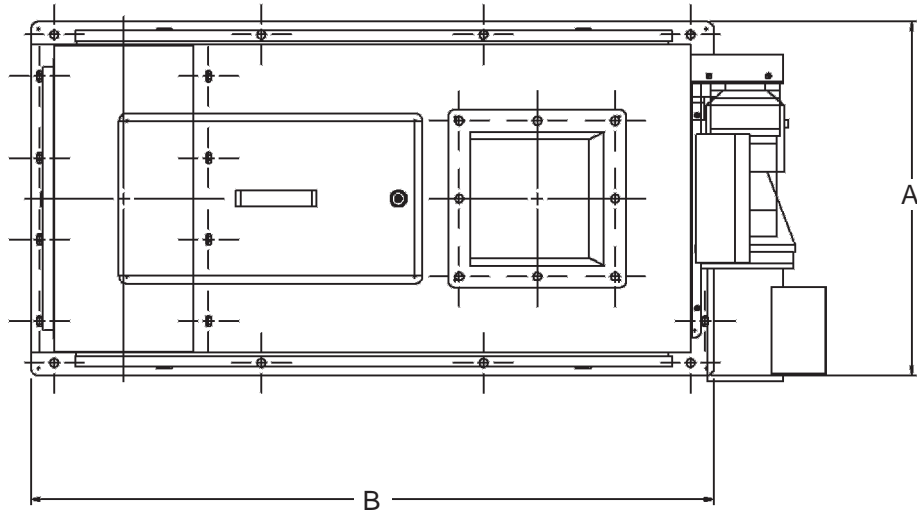

| STANDARD DIMENSIONS |       |       |       |       |       |       |       |
|---------------------|-------|-------|-------|-------|-------|-------|-------|
| TYPE                | A     | B     | C     | D     | E     | F     | G     |
| DEA 300             | 23.92 | 45.92 | 42.81 | 27.81 | 50.62 | 22.28 | 17.00 |
| DEA 600             | 35.92 | 51.48 | 48.37 | 30.56 | 56.18 | 34.28 | 17.00 |